

DESCRIPTION

FTTH terminal box CNFODB-16I can connect the drop cable with feeder cable as the termination point in the FTTH network, which is cable to meet at least 16 users requirements. It can help splicing, splitting, storage and management with suitable space.

FEATURES

- Material: ABS
- Sealing Method: Mechanical seal
- IP Rate: IP65
- Installation: In line
- Size of cable inlet: 3 inlets/outlets, Max cable diameter of inlet/ outlet $\phi 15$
- 16 drop cable outlets

PACKING INFORMATION

Package size (CM)	Q' ty
Inner box 38.5*30*10	1 pc
Outer box 54*40*32	5 pcs



SIZE

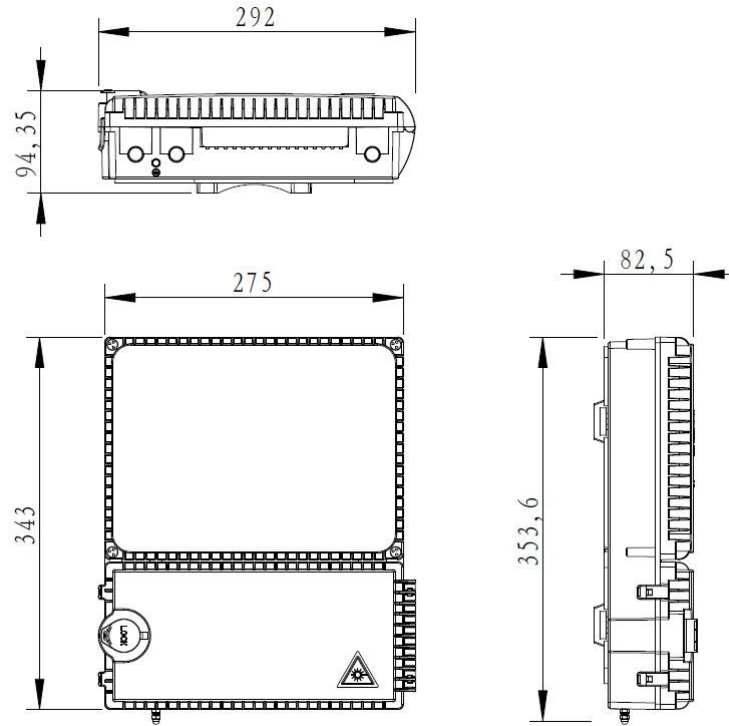

PRODUCT CABLE WAYS

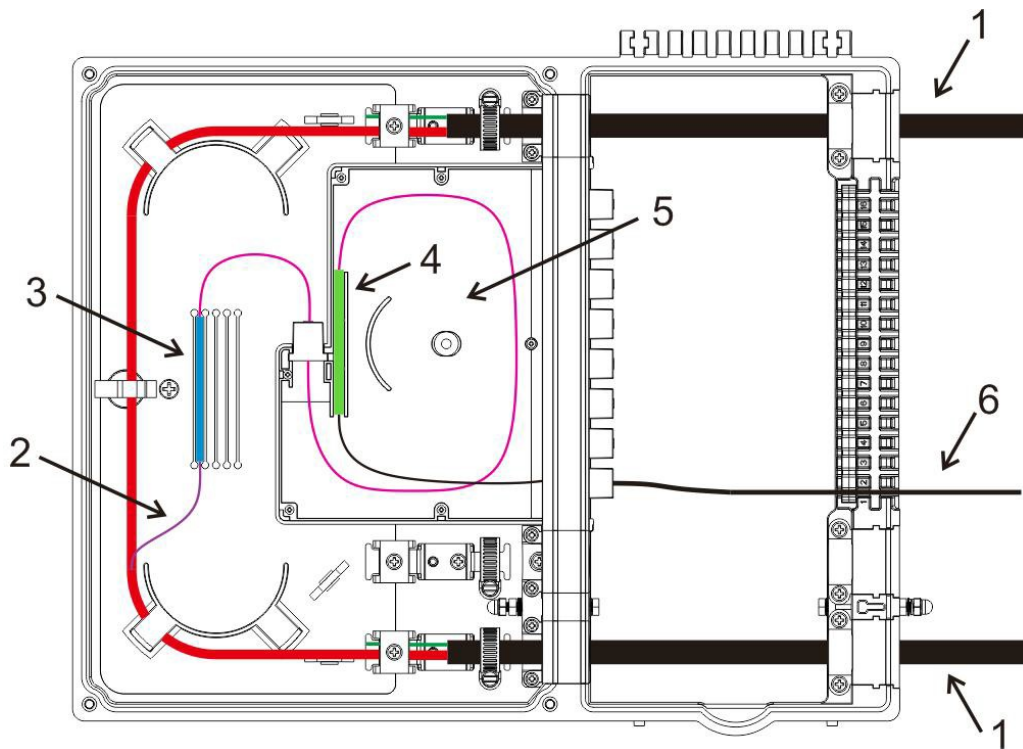

1--Input
4--PLC Splitter

2--Pigtail
5--Slot Box

3--Protection Sleeve
6--Output



ACCESSORIES

Item	Name	Model	Unit	Q' ty
1	Protection Sleeve	60MM*3.0*1.5	PCS	16
2	Nylon cable ties	3mm*200mm/Black	PCS	10
3	Spiral pipe	Outer diameter Φ 6mm/Plastic/White	M	1
4	Spiral pipe	Outer diameter Φ 8mm/Plastic/White	M	1
5	Insulating tape	0.15*17mm*8/Black	PCS	1
6	Screws	C type 4*30/Stainless steel 304	PCS	4
7	Expansion bolt	Φ 6mm/Plastic/White	PCS	4